



**BUILDING  
&  
DEVELOPMENT**

Call Kent Davick (806) 778-0288  
for more information.



# US 6 & Warrior Way

## GRAND JUNCTION, CO



.60 - 4.61 ac.



\$11.40 - \$19.13 psf

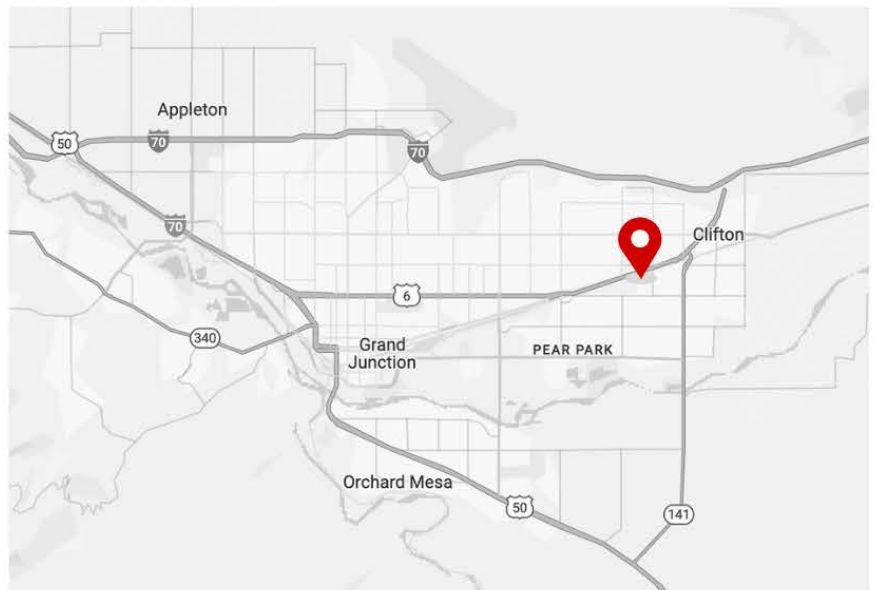





**BUILDING  
&  
DEVELOPMENT**

Call Kent Davick (806) 778-0288  
for more information.

# US 6 & Warrior Way

GRAND JUNCTION, CO

## Vehicles Per Day

- US 6: 20,529
- Warrior Way: 5,185
- E 1/2: 5,137

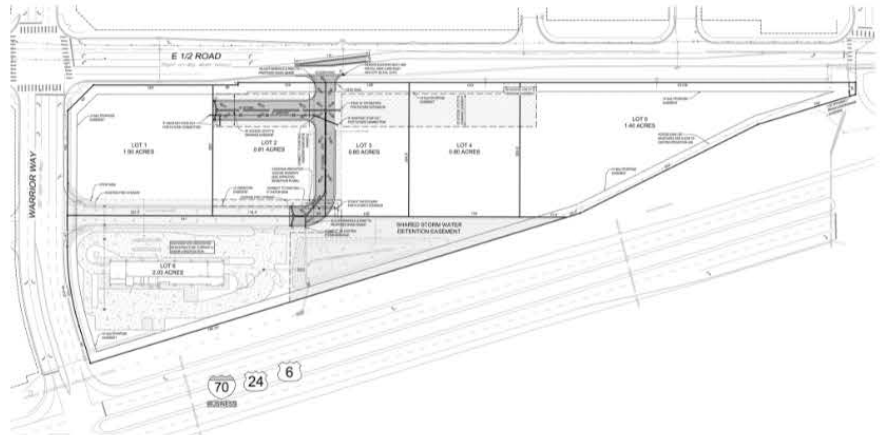

## Demographics

	3 Mile	5 Mile
Population	49,630	90,659
Household	18,749	35,871
Avg. Income	\$69,322	\$71,362

